

SAMPLE

3. CORNICE STYLE (SMALL COVE)

1. STYLE (FLUSH)

7. DOOR STYLE (LOUVER)

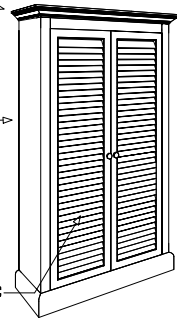

UNIT CODE: C42

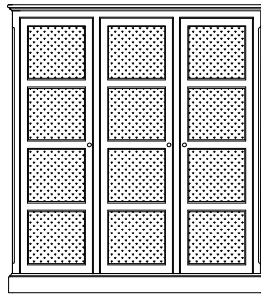

C62
METAL 4 PANEL DOORS
MOULDING ONLY CORNICE

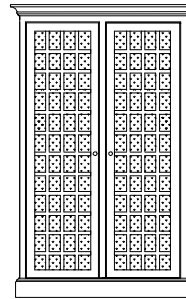

C42
GRID DOORS
SMALL COVE CORNICE

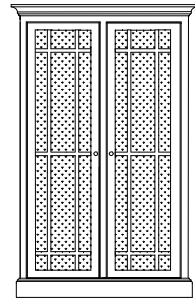

C42
CUSTOM GRID DOORS
SMALL COVE CORNICE

UNIT CODE (SELECT THE SIZE AND CONFIGURATION OF THE BASE)
SEE SELECTION SHEET INTRODUCTION FOR DIMENSION KEY.

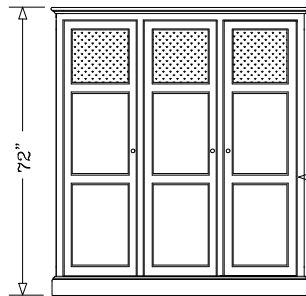
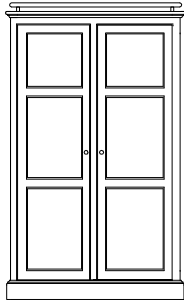

ALL FRAMES ARE
INSET, NON-BEADED
CONSTRUCTION

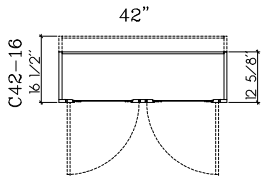

C42-12 15CF
C42-16 20CF

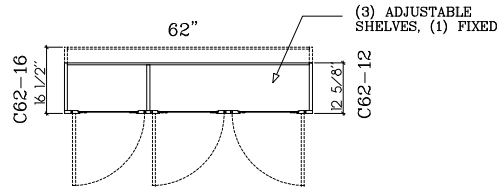

C62-12 23CF
C62-16

1. STYLE (SIDES)

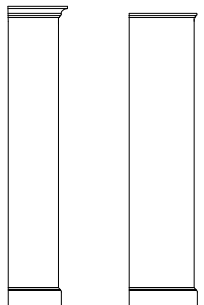

12 5/8" FLUSH
16 1/2"

1. STYLE (SIDES)

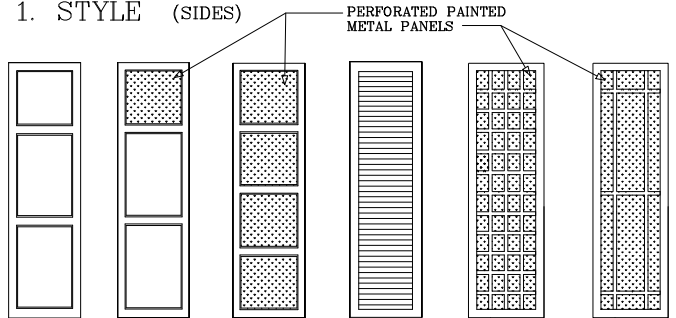

FLAT PANEL
FLAT PANEL W/VENT
METAL 4 PANEL
LOUVER
GRID
CUSTOM GRID

LOUVER DOORS AVAILABLE PAINTED
OR PINE ONLY.

3. CORNICE STYLE



SMALL
COVE



BAR
POL. BRASS OR MATTE NICKEL



MOULDING ONLY

SHALLOW CUPBOARDS C42 & C62 MAKE SELECTIONS BY CIRCLING DESIRED OPTIONS HERE

0911

15B

Y E S T E R T E C D E S I G N